

# Technical data sheet

## Earthing terminal for fastening on earthing strap

Item number: 5040507

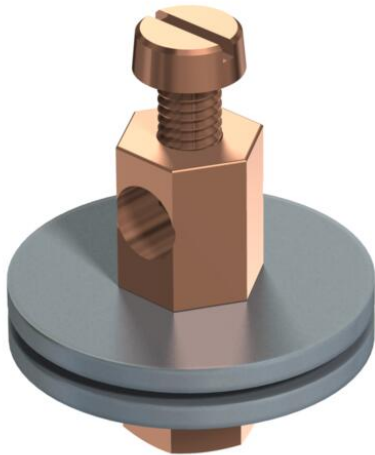

- For use in bathtubs or shower tubs etc.
- Connection option: conductors to 16 mm<sup>2</sup>
- Clamping element with threaded connection M6, 1 hexagonal nut M6, 1 serrated dimension washer and 1 cylinder bolt M5 x 8
- Clamping element, nut and screws from copper-plated brass
- Serrated washer from stainless steel; 2 washers from galvanised steel



Brass



Nickel-plated

### Master data

Item number	5040507
Type	928
Description 1	Connection terminal
Manufacturer	OBO
Dimension	1/2"
Material	Brass
Surface	Nickel-plated
Surface standard	
Smallest sales unit	10
Unit of quantity	Piece
Weight	5.7 kg
Weight unit	kg/100 pc.
CO2 Footprint (GWP) Cradle-to-Gate	0,1474 kg CO2e / 1 Piece

# Technical data sheet

## Earthing terminal for fastening on earthing strap

Item number: 5040507



### Dimensions

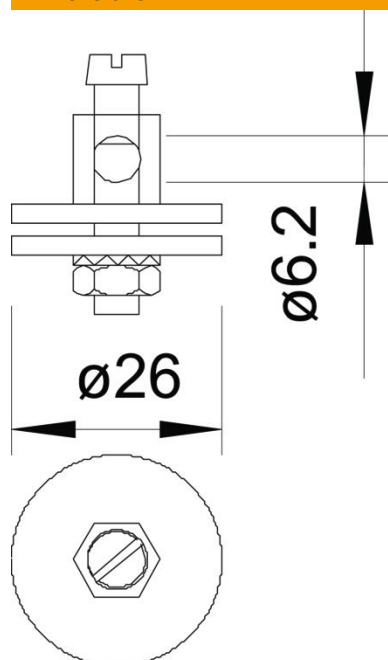

### Technical data

Suitable for

Round conductor