

Technical data sheet

Earthing terminal with fastening thread

Item no. 6404001



Earthing terminal for fastening the equipotential bonding wire to the cable support system. Suitable for conductor cross sections of 4–50 mm².



 Brass

Master data

Item no.	6404001
Type	EKL 25 M8
Description 1	Earthing terminal
Description 2	with M8 thread and screw
Dimension	25mm ²
Material	Brass
Material symbol	CuZn
Smallest sales unit (VG)	50 Piece
Weight	3,97 kg/100 pc.

Technical data

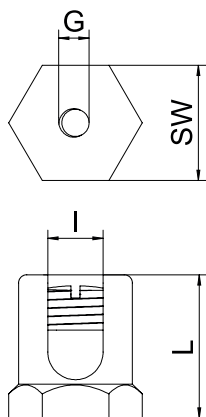

Length	25,00 mm
Dimension L	26,00 mm
Dimension I	10,00 mm
Suitable for cable tray	<input checked="" type="checkbox"/>
Suitable for mesh cable tray	<input type="checkbox"/>
Suitable for cable ladder	<input checked="" type="checkbox"/>
Suitable for maintaining electrical function	<input type="checkbox"/>
Thread	M8
With screw accessories	<input type="checkbox"/>
Cross-section	50,00 mm ²
Rustproof steel, pickled	<input type="checkbox"/>
Connection type	With pin/drill hole