

# Technical data sheet

## MS4121 mounting rail, slot 22 mm, A4, perforated

Item number: 1122931



Heavy-duty C profile rail for individual installation of support constructions, e.g. for cable trays or as a panel for switchgear cabinets. Can also be used for cable routing, in conjunction with clamp clips with a U foot.



A4	Stainless steel
2B	Bright, treated

Master data		
Item number	1122931	
Type	MS4121P3000A4	
Description 1	Profile rail	
Description 2	perforated, slot 22mm	
Manufacturer	OBO	
Dimension	3000x41x21	
Material	Stainless steel 1.4571	
Surface	Bright, treated	
Surface standard		
Smallest sales unit	3	
Unit of quantity	Metre	
Weight	172.67 kg	
Weight unit	kg/100 m	
CO2 Footprint (GWP) Cradle-to-Gate	7,323 kg CO2e / 1 Meter	

# Technical data sheet

MS4121 mounting rail, slot 22 mm, A4, perforated

Item number: 1122931



## Dimensions

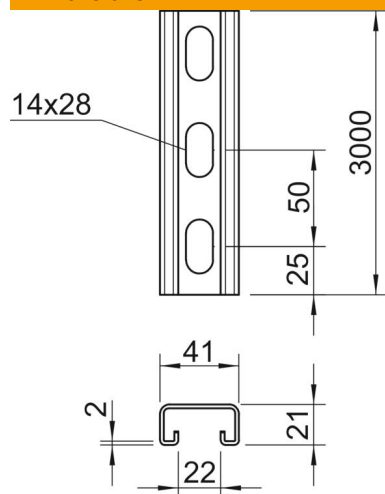

Length	3,000 mm
Width	41 mm
Height	21 mm
Dimension L	3,000 mm

## Technical data

Breakable	no
Type of perforation	Perforated back
Version for	Single profile
Drill hole spacing, centre	50 mm
Maintain electrical functions	yes
Hole size	14x28 mm
Material thickness	2 mm
With perforation	yes
With toothing	yes
Profile shape	C profile
Slot width	22 mm
Static value A	1.65 cm <sup>2</sup>
Static value I <sub>y</sub>	0.95 cm <sup>4</sup>
Static value I <sub>z</sub>	4.51 cm <sup>4</sup>
Static value W <sub>y</sub>	0.89 cm <sup>3</sup>
Static value W <sub>z</sub>	2.2 cm <sup>3</sup>