

Technical data sheet

Tilting anchor

Item no. 3482707



Including nut and large washer.

The universal heavy-duty fastening for stressed concrete, hollow steel profiles, metal sheets and plates.

Use: heating, ventilation and air conditioning technology, cooling systems, sprinkler systems, pipes, cable tracks, etc.

* Dependent on the thickness of the ceiling profile.



St	Steel
G	Electrogalvanised

Master data

Item no.	3482707
Type	KD 8 100
Description 1	Tilting anchors
Dimension	M8x100mm
Material	Steel
Material symbol	St
Surface	Electrogalvanised
Surface to DIN	EN ISO 19598 / EN ISO 4042
Surface symbol	G
Smallest sales unit (VG)	25 Piece
Weight	11,20 kg/100 pc.

Technical data

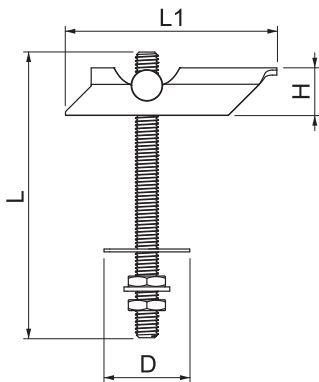

Length	100,00 mm
Dimension L	100,00 mm
Version for	With threaded shaft
Drill hole	22,00 Ø mm
Drill hole diameter	22,00 mm
Breaking load	2,40 kN
overall length	100,00 mm
Thread	M8
Minimum cavity depth	75,00 mm
With washer	<input checked="" type="checkbox"/>