

# Technical data sheet

## UP Flush-mounted device box 46, airtight

Item no. 2003706



Flush-mounted device box, with airtight membrane entries, for use in masonry with an installation depth of at least 46 mm.

- 4 x 3 screw domes
- Connector with bayonet lock, couplable on both sides
- 4 combination pipe entries of Ø 20 and 25 mm
- 2 entries up to Ø 20 mm in the connector
- 2 entries up to Ø 12 mm in the base

Tested according to DIN EN 60670-1, DIN EN 60670-22 and DIN 49073-1.



PP/TPE Polypropylene / thermoplastic elastomer

### Master data

Item no.	2003706
Type	UG 46-L
Description 1	UP Flush-mounted device box
Description 2	airtight
Available from	01.10.2021
Dimension	Ø60mm, H46mm
Colour	Jet black / blue-grey
Material	Polypropylene / thermoplastic elastomer
Material symbol	PP/TPE
Smallest sales unit (VG)	25 Piece
Weight	2,04 kg/100 pc.

### Technical data

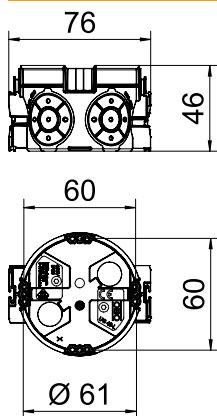

Height	46,00 mm
Diameter	60,00 mm
No. of entries	8
Type of entry	NYM cables, data cables and corrugated pipes
Type of housing penetration	Insertion membrane
Version for	Single
Shape	Device socket
Device fixing	Screws ,
Cover	Without
Cover fastening	Screws ,
Entry from rear	<input checked="" type="checkbox"/>
Flame-resistant	acc. to VDE 0471/IEC 60695-2-11, test temperature 650°C
Shape	Round
For pipe diameter	20/25 mm
Pipe entries Ø 12 mm	2
Pipe entries Ø 20 mm	2
Combination entries Ø 20 / 25 mm	4
Halogen-free	<input checked="" type="checkbox"/>
With nail strap	<input type="checkbox"/>
With bolts	<input type="checkbox"/>

# Technical data sheet

## UP Flush-mounted device box 46, airtight



Item no. 2003706



### Technical data

Nominal cross section	1,50 - 2,50 mm <sup>2</sup>
Rated voltage	400,00 V
Impact-resistant	<input checked="" type="checkbox"/>
Protection rating	IP30
Airtight	<input checked="" type="checkbox"/>

Table 1

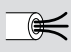
				
	1,5 mm <sup>2</sup>	2,5 mm <sup>2</sup>	1,5 mm <sup>2</sup>	2,5 mm <sup>2</sup>
			6	5
			20	15