

Technical data sheet

UP Flush-mounted device connection box 66, with device screws, airtight
Item no. 2003709



Flush-mounted device box, with airtight membrane entries, for use in masonry with an installation depth of at least 66 mm.

- 4 x 3 screw domes
- 2 pre-mounted device screws
- Connector with bayonet lock, couplable on both sides
- 4 combination pipe entries of Ø 20 and 25 mm
- 2 entries up to Ø 20 mm
- 6 entries up to Ø 12 mm
- 2 entries up to Ø 12 mm in the base

Tested according to DIN EN 60670-1, DIN EN 60670-22 and DIN 49073-1.



PP/TPE Polypropylene / thermoplastic elastomer

Master data

Item no.	2003709
Type	UG 66-GS-L
Description 1	UP Flush-mounted device box
Description 2	with device screws, airtight
Available from	01.10.2021
Dimension	Ø60mm, H66mm
Colour	Jet black / blue-grey
Material	Polypropylene / thermoplastic elastomer
Material symbol	PP/TPE
Smallest sales unit (VG)	25 Piece
Weight	2,63 kg/100 pc.

Technical data

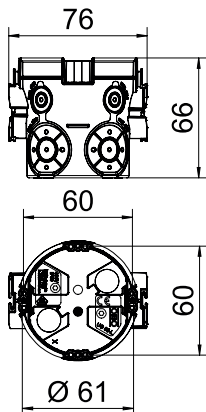

Height	66,00 mm
Diameter	60,00 mm
No. of entries	14
Type of entry	NYM cables, data cables and corrugated pipes
Type of housing penetration	Insertion membrane
Version for	Single
Shape	Device connection box
Device fixing	Screws or spreading claws
Cover	Without
Cover fastening	Screws ,
Entry from rear	<input checked="" type="checkbox"/>
Flame-resistant	acc. to VDE 0471/IEC 60695-2-11, test temperature 650°C
Shape	Round
For pipe diameter	20/25 mm
Pipe entries Ø 12 mm	8
Pipe entries Ø 20 mm	2
Combination entries Ø 20 / 25 mm	4
Halogen-free	<input checked="" type="checkbox"/>
With nail strap	<input type="checkbox"/>
With bolts	<input checked="" type="checkbox"/>
Nominal cross section	1,50 - 2,50 mm²

Technical data sheet



UP Flush-mounted device connection box 66, with device screws, airtight
Item no. 2003709



Technical data

Rated voltage	400,00 V
Impact-resistant	<input checked="" type="checkbox"/>
Protection rating	IP30
Airtight	<input checked="" type="checkbox"/>

Table 1

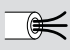
				
	1,5 mm ²	2,5 mm ²	1,5 mm ²	2,5 mm ²
	5	4	7	5
	15	12	21	15