

Technical data sheet

Service pole, type ISSDHSM45

Item no. 6289982



ISS service pole made from aluminium with 45 mm system opening for the direct installation of Modul 45 switching and connection devices.

Pole consists of:

1 two-compartment pole with stand

Total length 670 mm

2 aluminium covers

Length 670 mm

The design of this service pole is based on an extremely narrow, oval aluminium profile which shows on both narrow sides of the oval a cover of the Rapid 45 device installation trunking series.

The 45 mm system opening is suitable for direct acceptance of Modul 45® switching and connection devices. The installation area is theoretically sufficient for 2 x 14 Modul 45® devices. If Modul 45connect® is used or in the case of cabling requiring a lot of space, the number of the max. installable devices is reduced. There is the option to install a partition, type 2371/40 (6023096).



Alu Aluminium

EL Anodised

Master data

Item no.	6289982
Type	ISSDHSM45EL
Description 1	Service pole
Description 2	floor
Dimension	676x135x185
Material	Aluminium
Material symbol	Alu
Surface	Anodised
Surface symbol	EL
Smallest sales unit (VG)	1 Piece
Weight	281,50 kg/100 pc.

Technical data

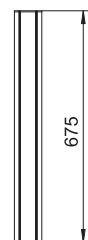
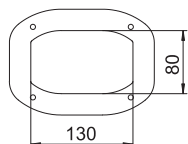

Length	676,00 mm
Width	135,00 mm
Height	185,00 mm
Pole height	675,00 - 675,00 mm
Number of usable covers	2
Number of fixed partitions	0
Number of compartments	2,00 pc.
Version for	Single-sided
Fastening type	Screw
Floor mounting	<input checked="" type="checkbox"/>
Ceiling mounting	<input type="checkbox"/>
Continuous profile	<input checked="" type="checkbox"/>
Height compensation	0,00 mm
Cable entry	Bottom
Changes according to location	<input type="checkbox"/>
Cover width (integer)	45
Pole shape	Oval
Adjustable	<input type="checkbox"/>
Pre-wired	<input type="checkbox"/>